

Waters 24 times per day.

HOW OFTEN

HOW LONG

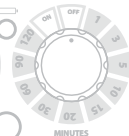

melnor®

Waters once per day.

Read First:

The **HOW OFTEN** knob of the Pump/Control Unit is set in hours.

Setting this knob to **1** will result in watering **once every hour** and will quickly deplete the battery.

To run the water pump **once per day**, set the **HOW OFTEN** knob to **24**.

Use the **HOW LONG** knob to set the number of minutes for each watering session.

Reference Step 7, Diagram 2 of the instructions for more details.

Read all instructions before using the Potted Plant Watering Kit.

melnor®

Potted Plant Watering Kit

User Instructions ■ English

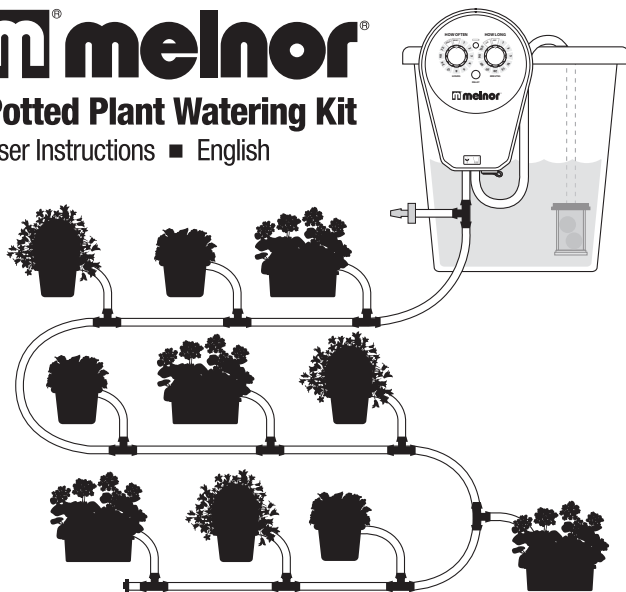

15100_INS_ENG_00 Copyright © 2017 Melnor, Inc.

The Melnor® Potted Plant Watering Kit contains:

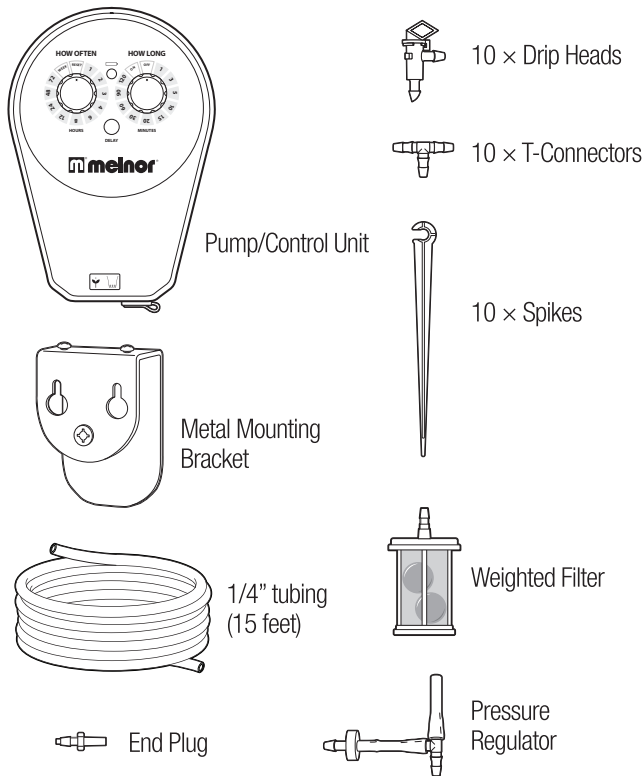

Items you will need to supply:

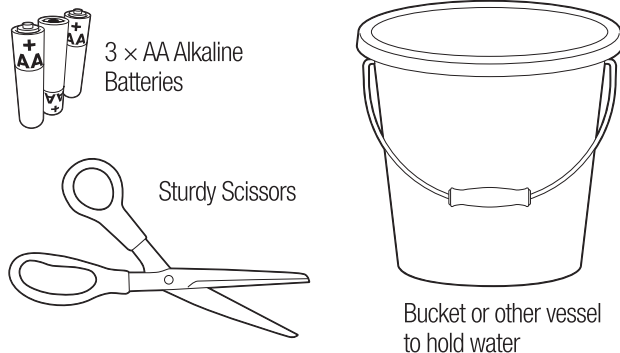

1

Remove the battery cover from the back of the Pump/Control Unit. Install 3 fresh AA Alkaline Batteries and replace the cover.

Ensure the cover is snug.

The LED on the front of the Pump/Control Unit will begin to blink (refer to the chart below).

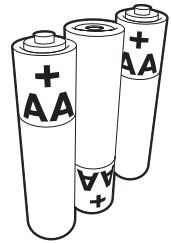

LED Blinking Pattern	Reason
LED blinks once every 4 seconds	Unit is working normally
LED is rapidly blinking – or – no LED activity	Replace batteries

2

Place the water bucket close to the potted plants being watered.

Hang the metal mounting bracket on the outer edge of the water bucket, with the longer side on the outside (or attach the metal mounting bracket to a wall surface next to the water bucket).

Hang the Pump/Control Unit from the small peg on the outside of the metal mounting bracket.

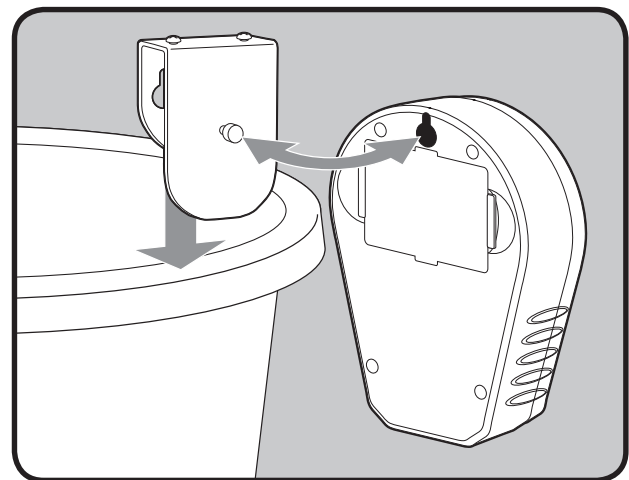

3

Measure sufficient tubing to run from the Pump/Control Unit intake to the bottom of the water bucket. Carefully cut tubing with scissors.

Press one end of the tubing onto the Pump/Control Unit intake and the other onto the weighted filter. Place the filter inside the water bucket. It should rest on the bottom of the water bucket.

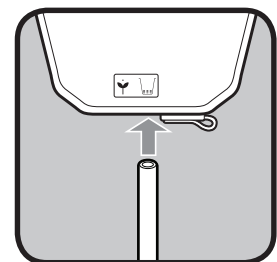
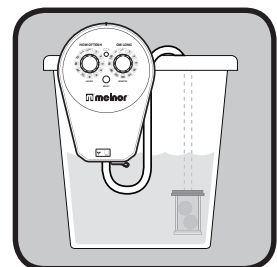

4

Press the open end of the Pressure Regulator tubing onto the Water Outlet of the Pump/Control Unit.



Using scissors, carefully cut tubing long enough to run between the Pump/Control Unit and the first plant to be watered. Attach the tubing to the bottom of the Pressure Regulator.

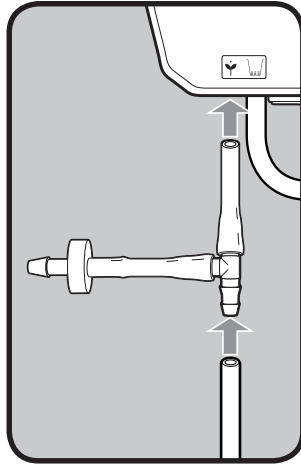

5

Using scissors, carefully cut tubing long enough to run between the plants and link together using the T-Connectors as shown in **Diagram 1**.

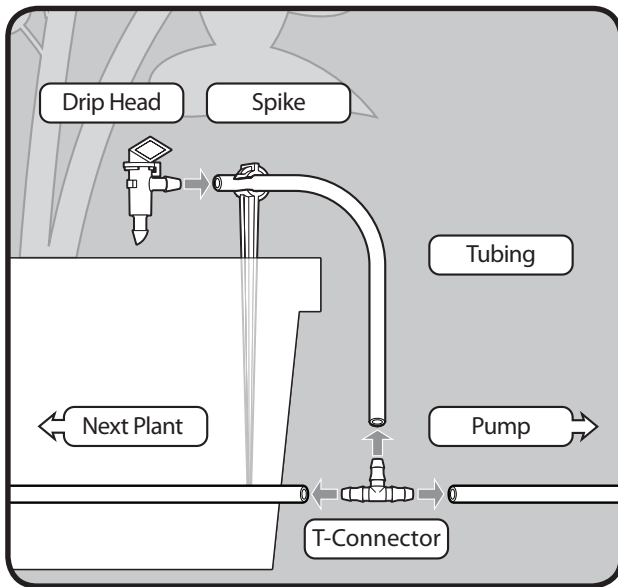
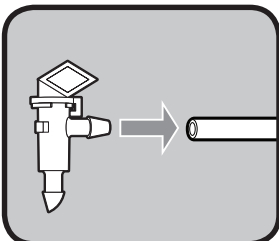

Diagram 1.

NOTE: If additional tubing is required, standard 1/4" tubing is readily available from most hardware stores and home improvement centers.

6

Install system in flower pots following the guide in **Diagram 1** for each potted plant. Make certain to use either the included End Plug or position a Drip Head at the very end of the tubing.



or

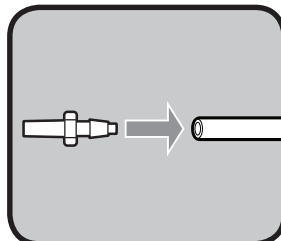

7

On the Pump/Control Unit, set how often you want to water using the **HOW OFTEN** knob. See explanations in **Diagram 2** below.

Setting	Once Every...	Watering Times
1	Once Every Hour	24 Times per Day
2	Once Every Other Hour	12 Times per Day
3	Once Every 3 Hours	8 Times per Day
4	Once Every 4 Hours	6 Times per Day
6	Once Every 6 Hours	4 Times per Day
8	Once Every 8 Hours	3 Times per Day
12	Once Every 12 Hours	Twice per Day
24	Once Every 24 Hours	Once per Day
48	Once Every 48 Hours	Once Every 2 Days
72	Once Every 72 Hours	Once Every 3 Days
Week	Once Every 7 Days	Once per Week

Diagram 2.

Set how long you want to water each time using the **HOW LONG** knob. The system will begin watering at the next available start time.

NOTE: We suggest you set up your system at the time of day you want to water.

8

OPTIONAL: If you want to change the initial start time, you may use the **DELAY START** button. See examples in **Diagram 3**.

Time you are setting your system	Time you want to begin watering	Press and Hold "Delay Start" for 2 seconds, then...
9:00pm	8:00am	Press "Delay Start" 11 times to move the start time to 8:00am
10:00am	6:00am	Press "Delay Start" 20 times to move the start time to 6:00am
3:00pm	5:00pm	Press "Delay Start" 2 times to move the start time to 5:00pm

Diagram 3.

9

Fill the water bucket with water. To adjust the flow to each flower, turn the **HOW LONG** knob to **ON**. Each Drip Head has a lever to adjust the amount of water going to each pot. This will allow you to match the watering to the plant's needs.

Once set, the Potted Plant Watering Kit will water your plants for you. All you need to do is keep water in the container.

Manual Watering

If you would like to add a little extra water to your potted plants, you can simply turn the **HOW OFTEN** knob to **NOW**. The pump will water for the preset amount of time.

If you need to water for a longer period, you can turn the **HOW OFTEN** knob to **NOW** and select **ON** using the **HOW LONG** knob. The pump will water continuously until you change the selection.

NOTE: Be careful not to allow the water to run dry as this could damage the pump.